

STRATEGIC LOCATION
优越地理位置



- Freehold
- Foreigners are Eligible to Buy
- 14km to CIQ
- Resort-Inspired Facilities
- 永久地契
- 外国人可购买
- 14公里直达新柔关卡
- 度假式休闲设备

Meridin Bayvue offers a prime strategic location near a number of shopping malls, provides convenience to residents. Golf Clubs & International Schools arriving in short drive.

美景湾坐落于新山便捷的地理位置，近市区，距离新柔关卡仅14公里。各大购物中心都近在咫尺，为您带来无比的便利。除此之外，各大高尔夫球场和国际学府也可在短时间内到达。

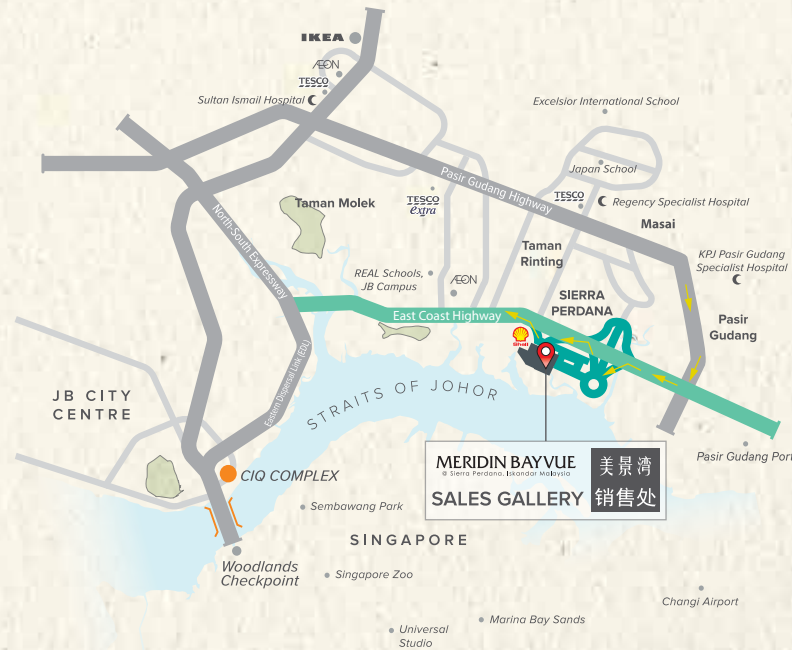

美景湾
MERIDIN BAYVUE
@ Sierra Perdana, Iskandar Malaysia

URBAN LIVING BY THE SEA
时尚海景公寓



Reinvent Spaces. Enhance Life.

MahSing

MERIDIN BAYVUE

A1-G-6 & A1-G-07 Pangsapuri Sierra Meridin,
Block A1 Jalan Sierra Perdana 6/3,
Taman Sierra Perdana, 81750 Masai, Johor.

07 291 3218
meridinbayvue.com.my

Meridin Bayvue@ Sierra Perdana • Caspian / Covil • Developer Name : Venice View Development Sdn. Bhd. (711563-V) (A wholly owned subsidiary of Mah Sing Group Berhad) • Developer License No. : 10279-4/07-2020/02194(L) • Validity Period: 20/7/2019 - 19/7/2020 • Advertising & Sales Permit No. : 10279-4/07-2020/02194(P) • Validity Period: 20/7/2019 - 19/7/2020 • Approving Authority: Majlis Bandaraya Johor Bahru • Building Plan Approval No. : MJB/U/2013/63/STK/KM/37 • Tenure of Land: Freehold • Land Encumbrances: NIL • Expected Completion: Block A1,A2 (June 2018), Block B1,B2 (June 2019) • Selling Price: • Block A1-RM487,500(Min) RM639,600(Max)-Total Units: 294 • Block A2 - RM523,900(Min) RM674,700(Max)-Total Units: 294 • Block B1-RM648,700(Min) RM845,000(Max)-Total Units: 294 • Block B2-RM648,700(Min) RM845,000(Max)-Total Units: 294 • All art renderings and photographs contained in this circular/ advertisement are artist's impression only. The developer reserves the right to modify any parts of the building prior to completion as directed or approved by relevant authorities. All plans, layouts, information and specifications are subject to change and cannot form part of an offer or contract presentation.

IKLAN INI TELAH DILULUSKAN OLEH JABATAN PERUMAHAN NEGARA

* Actual Photo

AN EXCITEMENT FOR LIFE THAT STARTS AT YOUR DOORSTEP

Surrounded by extensive green landscaping and located just 500m from breathtaking seaviews, your new address is a heartwarming invitation to enjoy a rejuvenating lifestyle. Top-notch facilities and retail pleasures add an element of adventure to each carefree day, so you can spice up your life the way you like it.

美好生活，足步可达

一望无际的海景与绿意盎然的景观尽收眼帘
一流的设施和零售商店全都足步可达
美景湾满足您生活配套需求的家园

SITE PLAN 公寓平面图

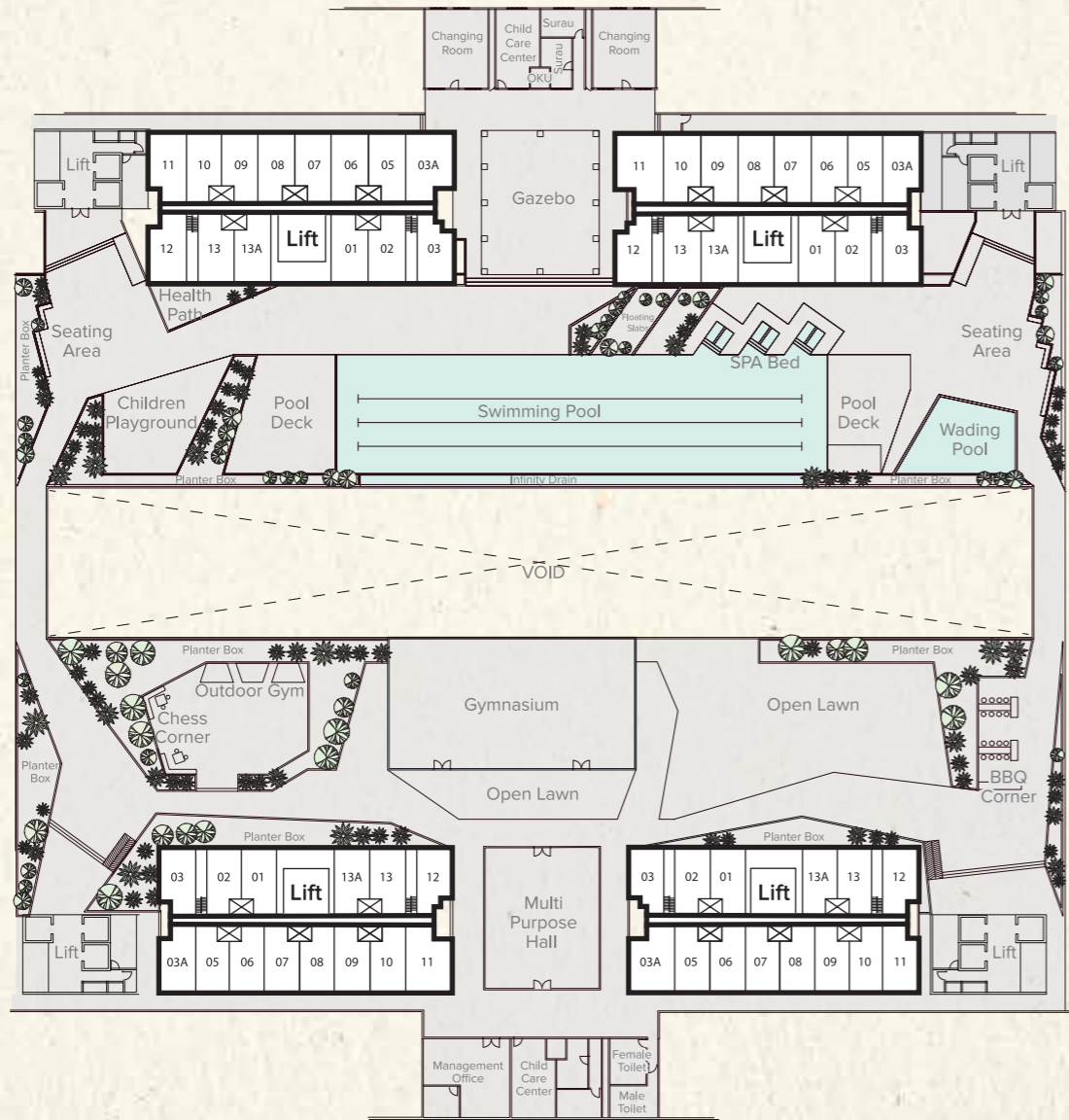

LEVEL 3A RECREATIONAL PODIUM 配套设施

- 1 Swimming Pool 泳池
- 8 Floating Slabs 亲水平台
- 2 Wading Pool 儿童泳池
- 9 Gymnasium 健身房
- 3 Children's Playground 儿童空中乐园
- 10 Multipurpose Hall 多用途广场
- 4 Seating Area 休闲区
- 11 Chess Corner 棋艺交流区
- 5 Health Path 健康步道
- 12 BBQ Corner 烧烤区
- 6 Pool Deck 甲板
- 13 Open Lawn 开放式草坪
- 7 Gazebo 凉亭

FLOOR PLAN 户型图

每层3梯14户
3 Bedrooms 卧房
2 Bathrooms 浴室

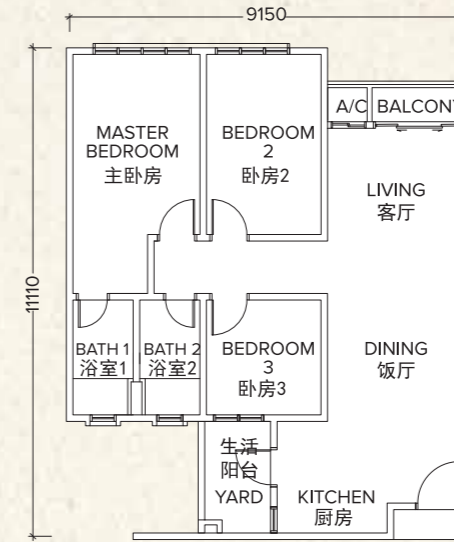

TYPE B
户型 B
实用面积:
91m²

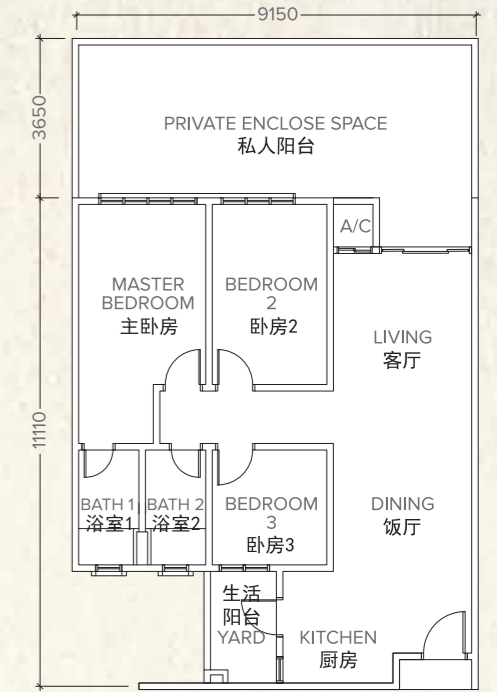

TYPE B1
户型 B1
实用面积:
111m² - 117.7m² (包含私人阳台)

MULTI-TIER SECURITY 多层保安系统 • CCTV 监控保安 • ACCESS CARDS 智能通行卡住住处及停车单位



* Actual Photo



* Actual Photo